

For more details on our fares please visit our website at Broward.org/BCT or call customer service: 954-357-8400.

Reading a Timetable - It's Easy

1. The map shows the exact bus route.
2. Major route intersections are called time points. Time points are shown with the symbol □.
3. The timetable lists major time points for bus route. Listed under time points are scheduled departure times.
4. Reading from left to right, indicates the time for each bus trip.
5. The bus picks up and drops off riders at all BCT bus stop signs along the route where there is a Broward County bus stop sign.
6. Arrive at the bus stop five minutes early. Buses operate as close to published timetables as traffic conditions allow.

Not paying your fare is a crime per Florida Statute 812.015.

Violation constitutes a misdemeanor, punishable by jail time and/or a fine.

Information: 954-357-8400

Hearing-speech impaired:
Florida Relay Service- 711 or 1-800-955-8771
TTY- 954-357-8302

This publication can be made available in alternative formats upon request.



This symbol is used on bus stop signs to indicate accessible bus stops.



BROWARD COUNTY
BOARD OF COUNTY COMMISSIONERS
An equal opportunity employer and provider of services.

Broward County Transit

Route 23 Weekday schedule

Pembroke Lakes Mall to
Sawgrass Mills Mall

Effective 3/6/23



Safety Is Our Number One Priority



**Mobile
Ticketing
App**

Now Your **Phone** Is Your
Ticket to ride BCT!
Download the App today.

MyRide
BROWARD.org

Real Time Bus Information
MyRide.Broward.org

**BROWARD
COUNTY**
Transit



Broward.org/BCT
954-357-8400

Route 23

Pembroke Lakes Mall to Sawgrass Mills Mall

MONDAY - FRIDAY

NORTHBOUND

To Sawgrass Mills Mall

PEMBROKE LAKES MALL	ACADEMIC VILLAGE	CLEVELAND CLINIC	SAWGRASS MILLS MALL
1	2	3	4
6:30a	6:48a	7:05a	7:30a
7:15a	7:33a	7:50a	8:15a
8:00a	8:18a	8:35a	9:00a
8:45a	9:00a	9:15a	9:35aG
9:30a	9:45a	10:00a	10:20aG
3:30p	3:48p	4:05p	4:30p
4:15p	4:33p	4:50p	5:15p
5:00p	5:18p	5:35p	6:00p
5:45p	6:03p	6:20p	6:45p
6:30p	6:45p	7:00p	7:20pG

SOUTHBOUND

To Pembroke Lakes Mall

SAWGRASS MILLS MALL	CLEVELAND CLINIC	ACADEMIC VILLAGE	PEMBROKE LAKES MALL
4	3	2	1
6:10a	6:35a	6:52a	7:10a
6:50a	7:15a	7:32a	7:50a
7:35a	8:00a	8:17a	8:35a
8:20a	8:45a	9:02a	9:20a
9:15a	9:35a	9:50a	10:05aG
3:10p	3:35p	3:52p	4:10p
3:50p	4:15p	4:32p	4:50p
4:35p	5:00p	5:17p	5:35p
5:20p	5:45p	6:02p	6:20p
6:15p	6:35p	6:50p	7:05pG
6:50p	7:10p	7:25p	7:40pG

There are additional bus stops in between those listed.

ROUTE 23

Pembroke Lakes Mall to
Sawgrass Mills Mall

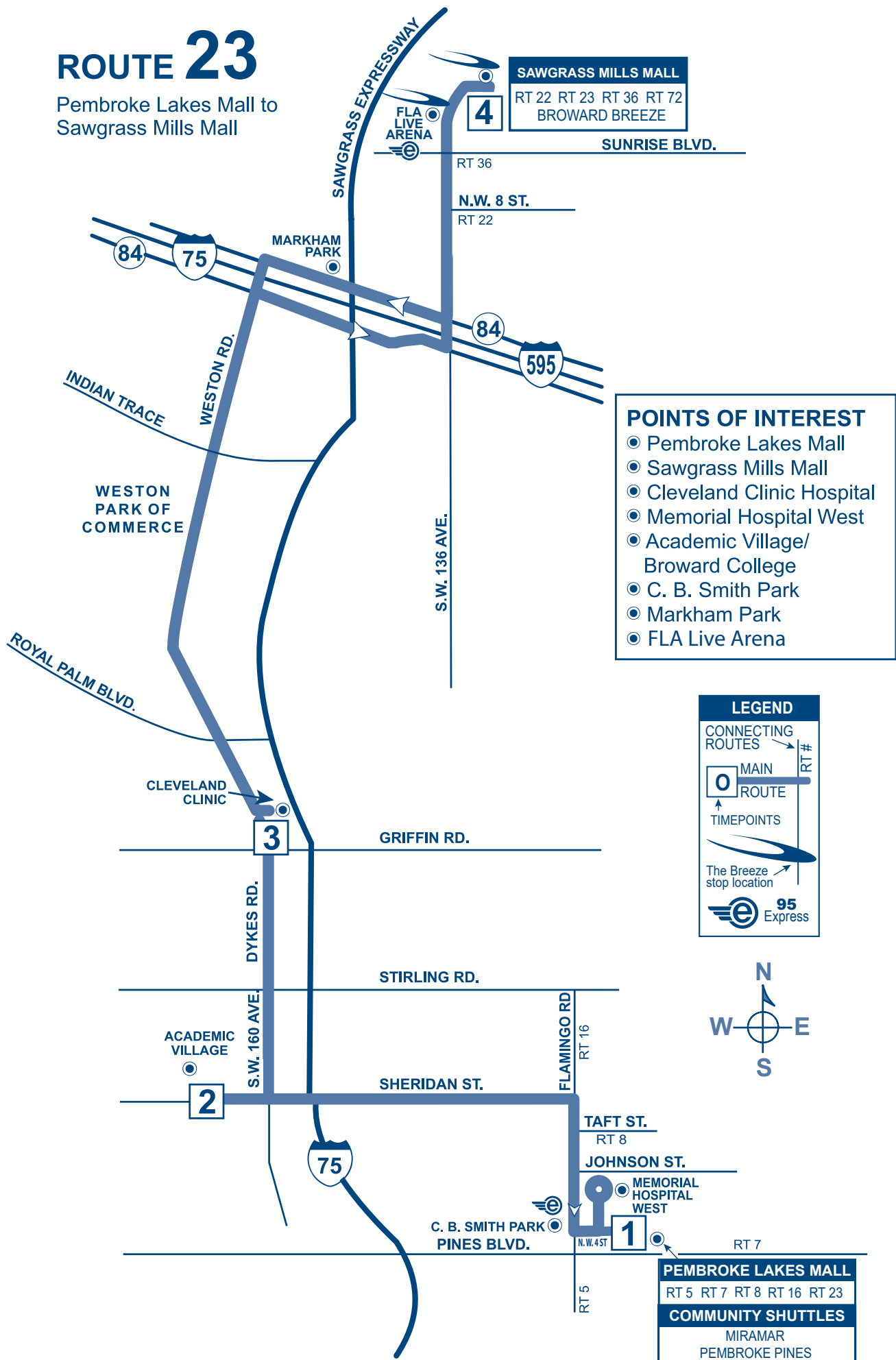

- POINTS OF INTEREST**
- Pembroke Lakes Mall
 - Sawgrass Mills Mall
 - Cleveland Clinic Hospital
 - Memorial Hospital West
 - Academic Village/
Broward College
 - C. B. Smith Park
 - Markham Park
 - FLA Live Arena

LEGEND

CONNECTING ROUTES → RT #

○ MAIN ROUTE

↑ TIMEPOINTS

The Breeze stop location

95 Express



PEMBROKE LAKES MALL
RT 5 RT 7 RT 8 RT 16 RT 23

COMMUNITY SHUTTLES
MIRAMAR
PEMBROKE PINES

Customer Service

Monday - Friday.....7AM - 7:45PM
Saturday, Sunday and Holidays.....8:30AM - 4:45PM
Transit Operations Agents help with:

- Trip planning
- Routes, times and transfer information
- Identifying bus pass sales locations
- Special event information

Lost and Found: 954-357-8400, Monday, Tuesday, Thursday and Friday, 9AM - 4PM

Holiday Bus Service

Sunday bus service is provided on the following holidays:

New Year's Day Labor Day Memorial Day
Independence Day Thanksgiving Day Christmas Day

Fares

Exact fare, dollar bill or coins required. Operators do not carry change.

Fares are: Regular, Premium Express, Senior/Youth/Disabled/Medicare.* Children (under 40 inches ride FREE)

Fare Deals

All Day Bus Pass offers unlimited rides on all routes. On sale aboard all BCT buses.

NOTE: Other cost saving passes cannot be purchased on BCT buses, but are available at the Central Bus Terminal and at authorized distributors.

10 Ride Pass: 10 Rides any time, any day. Expires after the tenth ride is taken.

7 Day Pass: Unlimited rides for seven consecutive days. Starts on the first day card is used. Expires after the seventh day.

31 Day Adult Pass: Unlimited rides for 31 consecutive days. Starts on the first day card is used.

31 Day Reduced Pass: Youth*, Seniors*, Disabled*, Medicare*, College Student*. Unlimited rides for 31 consecutive days. Starts on the first day card is used.

**Premium Express 10 Ride Pass: 10 rides any time, any day. Expires after tenth ride is taken.

**Premium Express 31 Day Pass: Unlimited rides for 31 consecutive days. Starts on the first day card is used.

Bus passes are not exchangeable, refundable or transferable. Damaged cards are invalid. Lost, stolen or damaged cards will not be replaced.

*NOTICE: Proof of age is required for Youth fare (18 years or younger) and for Senior fare (65 years or older). For College Student Bus Pass, a college photo ID card is required. For Disabled and Medicare fare, proof of disability (Medicare card) and photo I.D. is required. Eligible Senior fare patrons are encouraged to acquire their BCT Reduced Fare Photo ID cards.

** Premium Bus Pass can be purchased online at Broward.org/BCT and at select Broward County library locations.



TRANSIT WATCH

**WHEN IT COMES TO OUR SAFETY,
WE CAN ALWAYS USE AN EXTRA
PAIR OF EYES AND EARS.**

BE ALERT.

CALL 954-357-LOOK (5665).

TELL US.

PROTECTIONS OF TITLE VI OF THE CIVIL RIGHTS ACT OF 1964 AS AMENDED

Any person(s) or group(s) who believes that they have been subjected to discrimination because of race, color, or national origin, under any transit program or activity provided by Broward County Transit (BCT), may call 954-357-8481 to file a Title VI discrimination complaint or write to Broward County Transit Division, Compliance Manager, 1 N. University Drive, Suite 3100A, Plantation, FL 33324.

NUMBERS IN BOXES REFER TO TIME POINTS ON MAP

Times with the letter "G" before them indicate bus returns to garage.

To ensure reliable and safe connections for our customers, all trips with the "W" note will NOT depart terminal until directed by either the terminal supervisor or radio.